



Brand : CAE, China
 Name : THAMES Basin mixer with pop up waste set
 Item Code : 75.1229C
 Designer:
 Color / Finish: Chrome Plated
 Dimensions : 1201 mm height

Product info:

- Single lever basin mixer
- With pop-up waste
- Normal Spray
- Flow rate: 10.7 lpm at 3 bars (45 psi)
- Flow pressure: 0.3 Mpa

Add-ons:

- 2x angle valve $\frac{1}{2}$ "x $\frac{3}{8}$ " (no nuts)
- 1x basin waste trap $1\frac{1}{4}$ "

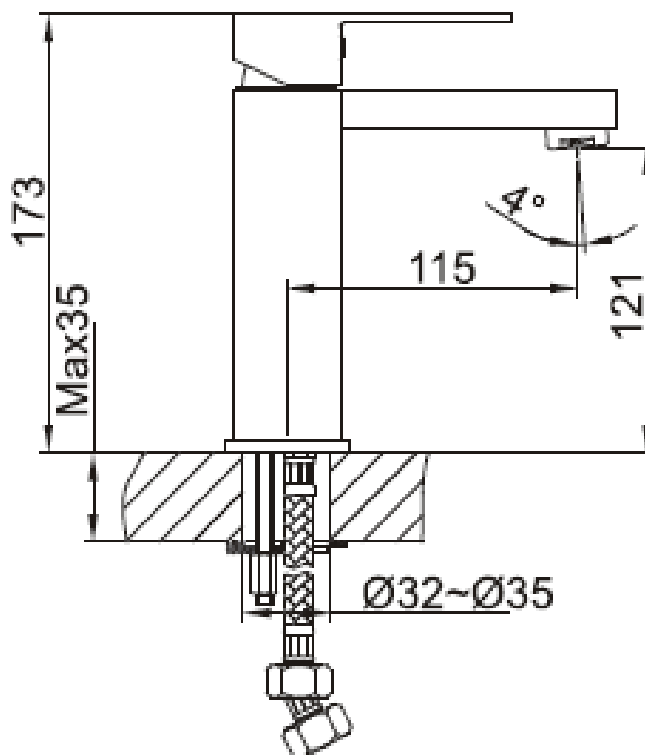

Flushing of pipe must be done before fittings are installed. Failure to do so voids the warranty.

Follow cleaning instructions and avoid using any harmful chemicals.

All information is for reference only. Installation shall always be based on the specs provided with actual delivered items.

For more info, visit www.sanitecph.com